

		CLIENT CONTACT		CLIENT DETAILS	
		CLIENT	EVENT	EVENT DATE	JOB NO.
<b>S O F I T E L</b> L U X U R Y H O T E L S		PROJECT MANAGER	DRAWING DATE	DRAWN BY	PAX
		VENUE	Broadbeach Room - Sofitel Gold Coast BroadBeach		
		81 SURF PARADE BROADBEACH, QLD. 4218. TEL.: (61 7) 5592 2250 ~ FAX.: (61 7) 5592 3747 www.avpartners.com			

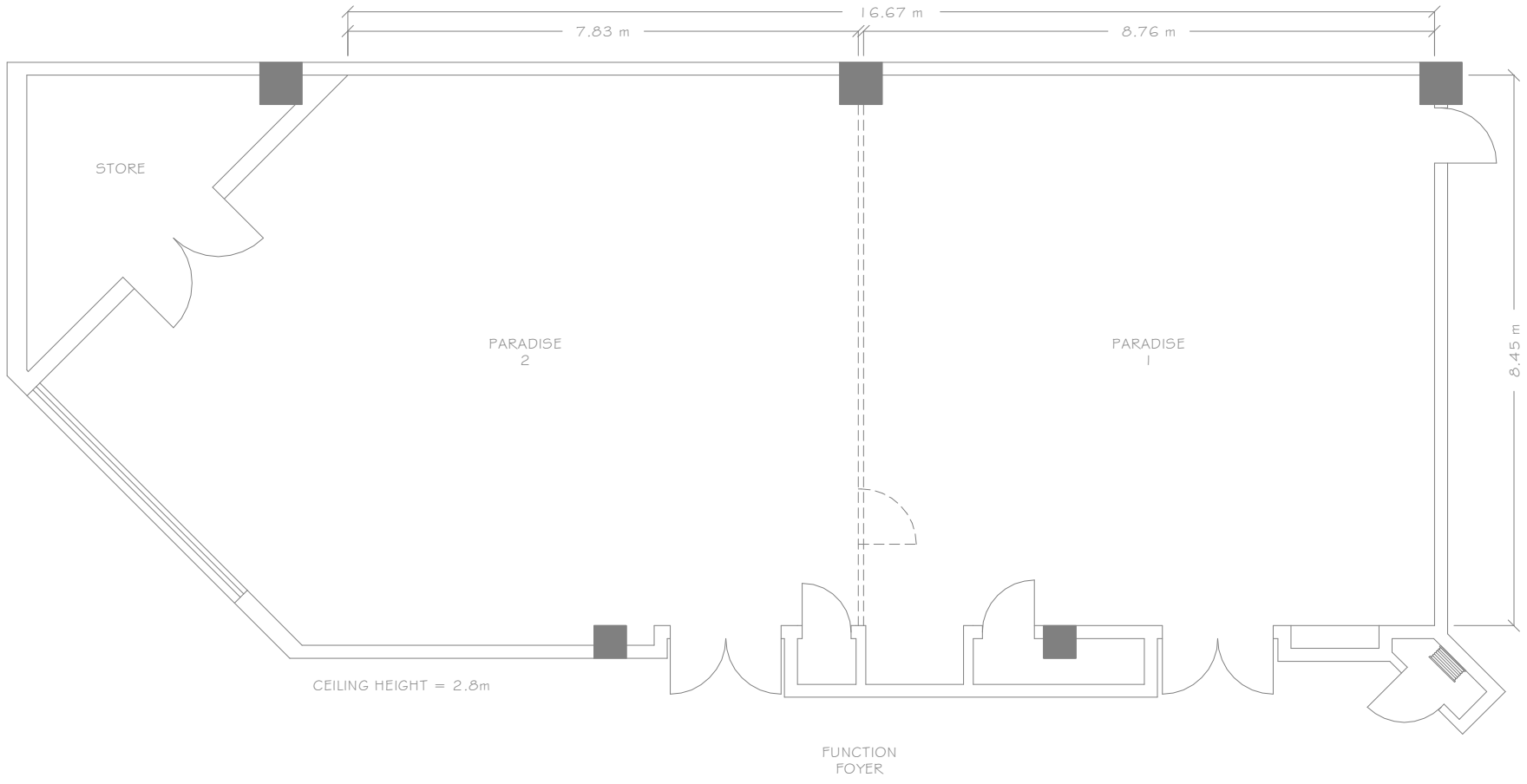

**AVPartners™**  
 81 SURF PARADE  
 BROADBEACH, QLD. 4218.  
 TEL.: (61 7) 5592 2250 ~ FAX.: (61 7) 5592 3747  
 www.avpartners.com

CLIENT	CLIENT CONTACT		CLIENT DETAILS	
	EVENT	EVENT DATE	JOB NO.	
	PROJECT MANAGER	DRAWING DATE	DRAWN BY	PAX
	VENUE	PARADISE ROOMS 1 + 2 ~ SOFTTEL GOLD COAST		

**S O F I T E L**  
 L U X U R Y H O T E L S



CEILING HEIGHT = 2.6

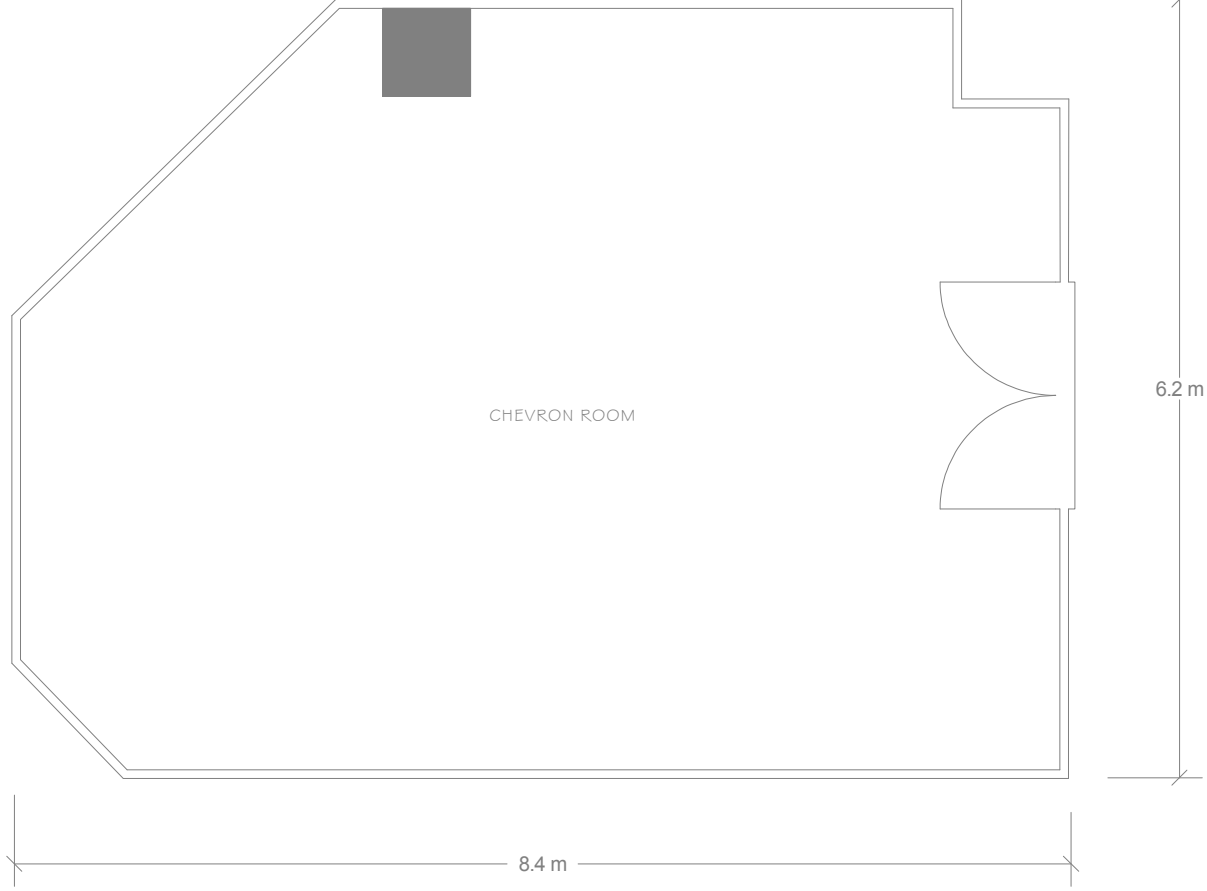

**SOFITEL**  
LUXURY HOTELS

CLIENT

CLIENT CONTACT

CLIENT DETAILS

EVENT

EVENT DATE

JOB NO.

PROJECT MANAGER

DRAWING DATE

DRAWN BY

PAX

VENUE

CHEVRON ROOM ~ SOFITEL GOLD COAST

**AVPartners™**

81 SURF PARADE,  
BROADBEACH, QLD. 4218.  
TEL.: (61 7) 5592 2250 ~ FAX.: (61 7) 5592 3747  
[www.avpartners.com](http://www.avpartners.com)

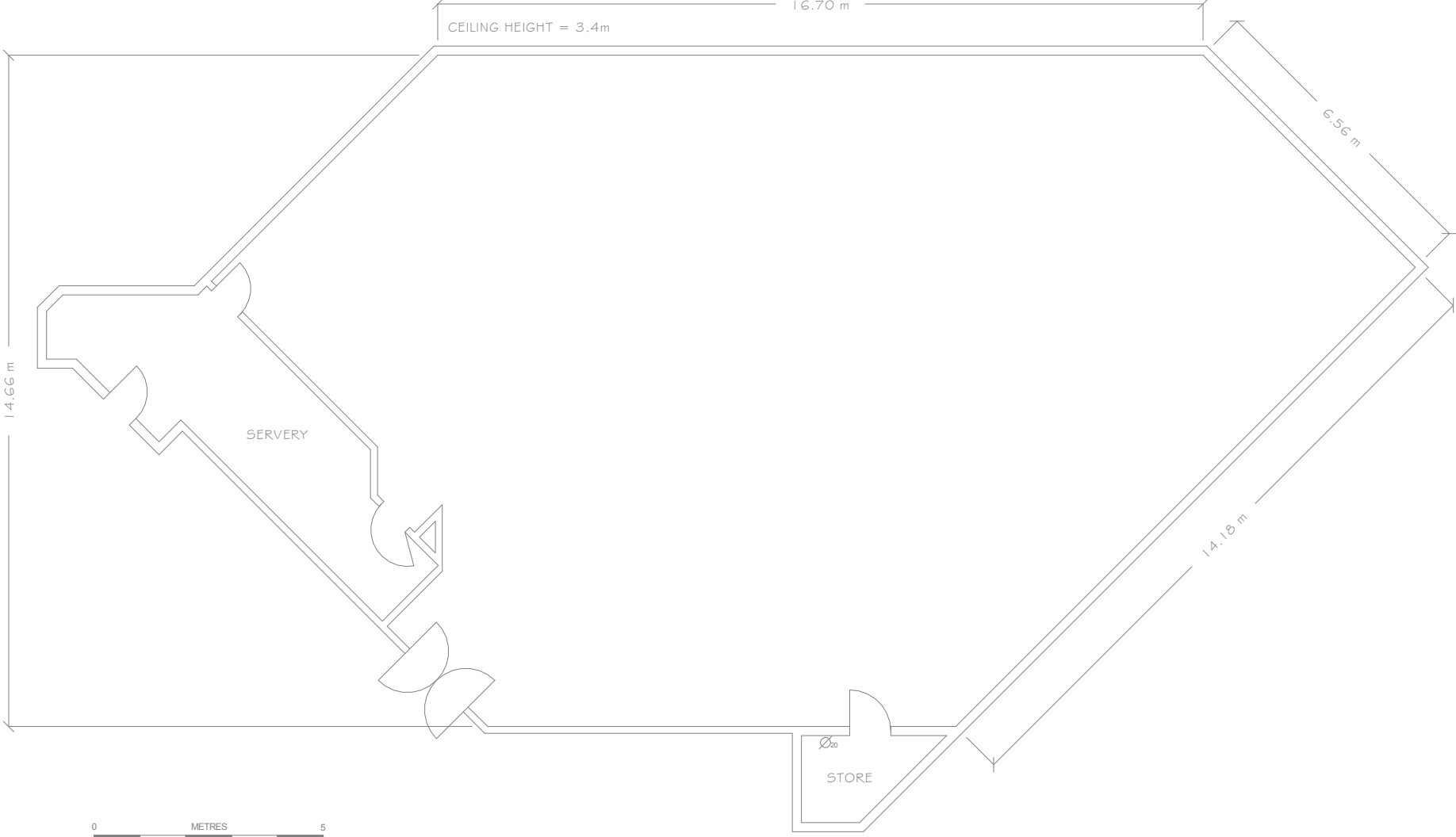

**AVPartners™**

81 SURF PARADE  
 BROADBEACH, QLD. 4218.  
 TEL.: (61 7) 5592 2250 ~ FAX.: (61 7) 5592 3747  
 www.avpartners.com

CLIENT	CLIENT CONTACT	CLIENT DETAILS	
EVENT	EVENT DATE	JOB NO.	
PROJECT MANAGER	DRAWING DATE	DRAWN BY	PAX
VENUE	SORRENTO ROOM - SOFITEL GOLD COAST		

**S O F I T E L**  
 L U X U R Y H O T E L S