

INSPIRED
MEETINGS & EVENTS



SOFITEL
HOTELS & RESORTS

SYDNEY WENTWORTH

SOFITEL SYDNEY WENTWORTH

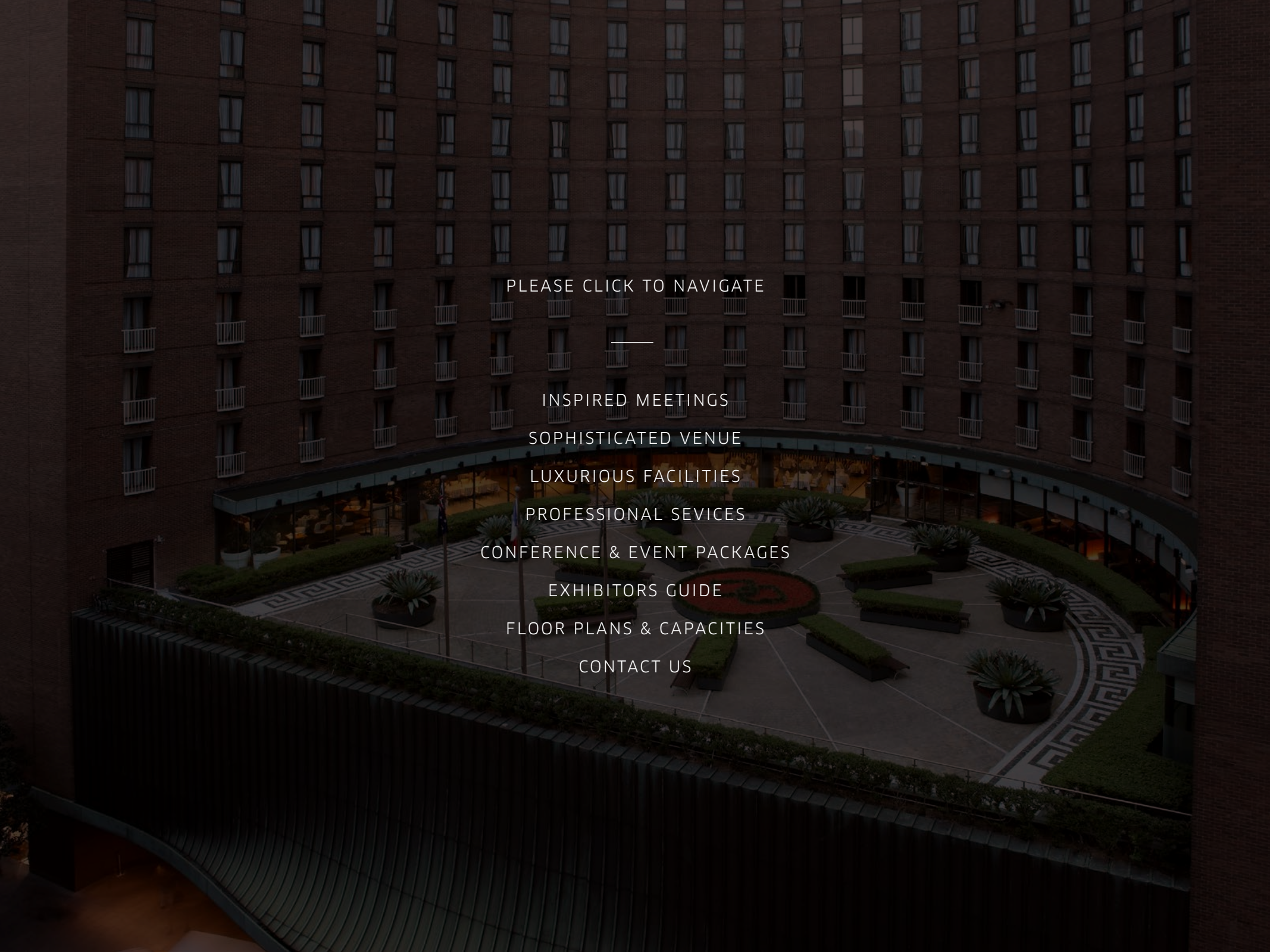

PLEASE CLICK TO NAVIGATE



[INSPIRED MEETINGS](#)

[SOPHISTICATED VENUE](#)

[LUXURIOUS FACILITIES](#)

[PROFESSIONAL SERVICES](#)

[CONFERENCE & EVENT PACKAGES](#)

[EXHIBITORS GUIDE](#)

[FLOOR PLANS & CAPACITIES](#)

[CONTACT US](#)

WELCOME

ELEGANTLY REFINED AND LUXURIOUSLY SOPHISTICATED, THE SOFITEL SYDNEY WENTWORTH REPRESENTS THE VERY ESSENCE OF TRUE LUXURY.

SITUATED IN THE HEART OF SPECTACULAR SYDNEY, THIS ICONIC 5-STAR HOTEL OFFERS A TRULY UNFORGETTABLE STAY, PROVIDING IMPECCABLE SERVICE, METICULOUS ATTENTION TO DETAIL AND BEAUTIFUL HERITAGE FEATURES WITHIN A FRESH, MODERN DESIGN. IMBUED WITH FRENCH ELEGANCE AND INSPIRED BY THE ART DE VIVRE, SOFITEL APPRECIATES THE TRUE MEANING OF SERVICE - OBSERVING A SPECIAL ATTENTION TO DESIGN, CONTINUING A CONSTANT CELEBRATION OF GASTRONOMY, AND MAINTAINING AN ONGOING PASSION FOR CULTURE.

THE VENUE

Each stylish function space features natural daylight, state of the art Audio Visual technology, touch pad lighting control and high speed internet facilities with full wifi coverage. The third floor of the hotel is completely dedicated to conferences and events, featuring a large foyer area that is suitable for use as exhibition space as well as session break-outs or pre-function gatherings.

**FOR CONFERENCE & EVENT ENQUIRES,
PLEASE CALL (02) 9228 9180 OR EMAIL
SOFITELSYDNEYSALES@SOFITEL.COM**

FACILITIES

394 Rooms & 42 Suites

including:

- 1 Wentworth Suite
- 3 Prestige Suites
- 24 Junior Suites

11 Meeting Rooms

including:

- 1 Pillarless Wentworth Ballroom
- Dedicated Conference Floors
- Break Out Foyer
- Club Millésime
- 1 Restaurant
- 1 Bar
- Secure Parking
- So Fit - Elixir
- Wentworth Hair and Beauty Salon
- Business Centre

SOFITELSYDNEY.COM.AU/INSPIREDMEETINGS

INSPIREDMEETINGS™

Dedicated to providing InspiredMeetings™ and Events, our experienced meetings and conference team is on hand to work closely with event organisers, ensuring every detail goes as planned for a completely seamless experience.

Our InspiredMeetings™ team works closely with our expert chefs and professional banquets team to provide unforgettable cuisine, while our in-house Staging and Event Production team provide creative Audio Visual solutions, in-depth knowledge of the venue.

Event organisers can choose from a range of magnificent conference packages, with the ability to fully tailor each event.

AUDIO VISUAL [➤](#)

AUDIO VISUAL

Luxuriously stylish, each of our contemporary event spaces features a thoughtful design, offering a range of function layouts to cater for a variety of events. Our function rooms contain permanently-installed state-of-the-art equipment, including conference IT equipment, touch-pad lighting controls, the latest Audio Visual technology, and high-speed internet connectivity with full Wi-Fi coverage. Meanwhile, our integrated control room allows our technical team to keep a close watch on all conference technology.

FOR FURTHER INFORMATION,
PLEASE CALL (02) 9228 9180 OR EMAIL
SOFITELSYDNEYSALES@SOFITEL.COM

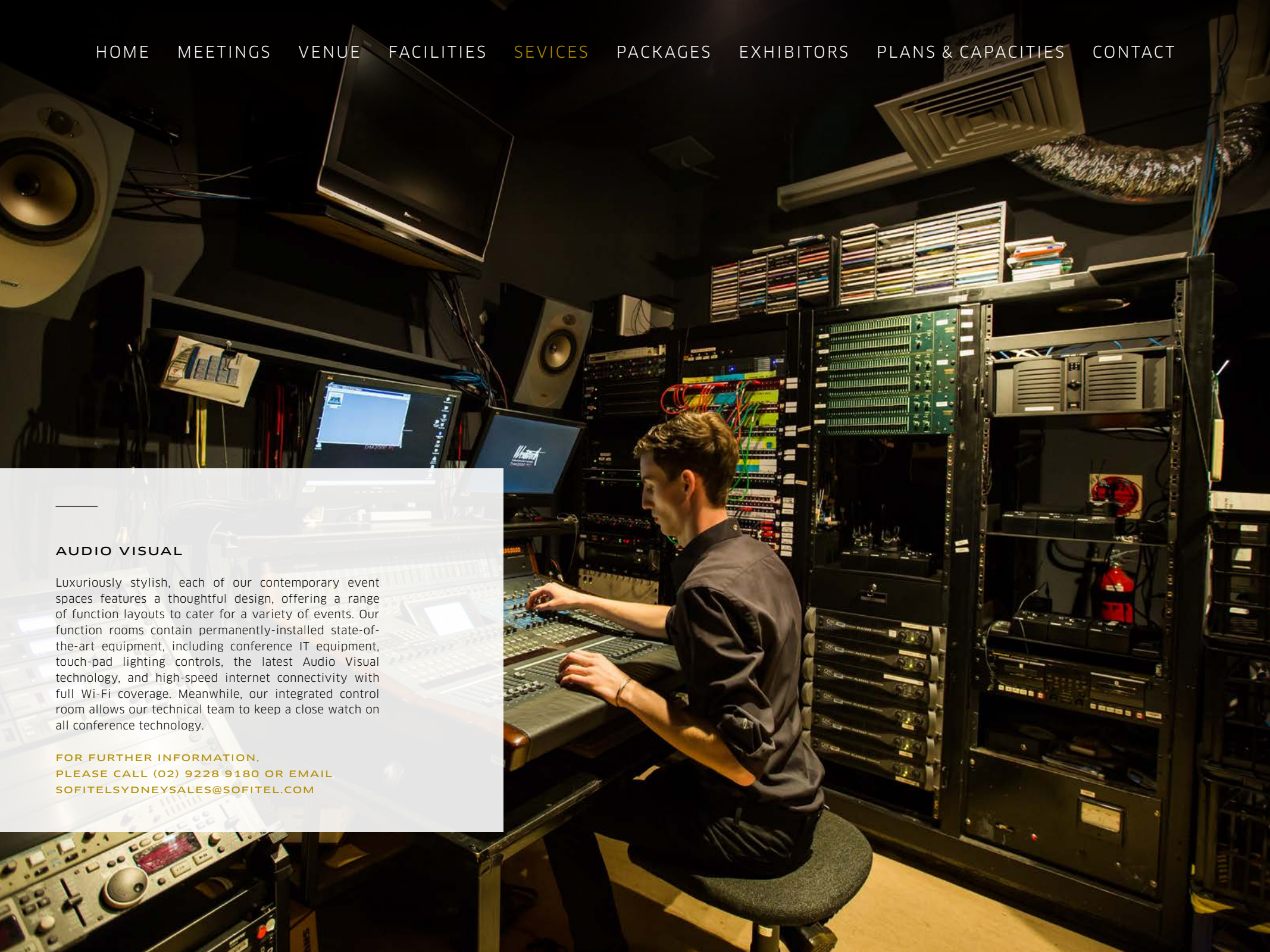

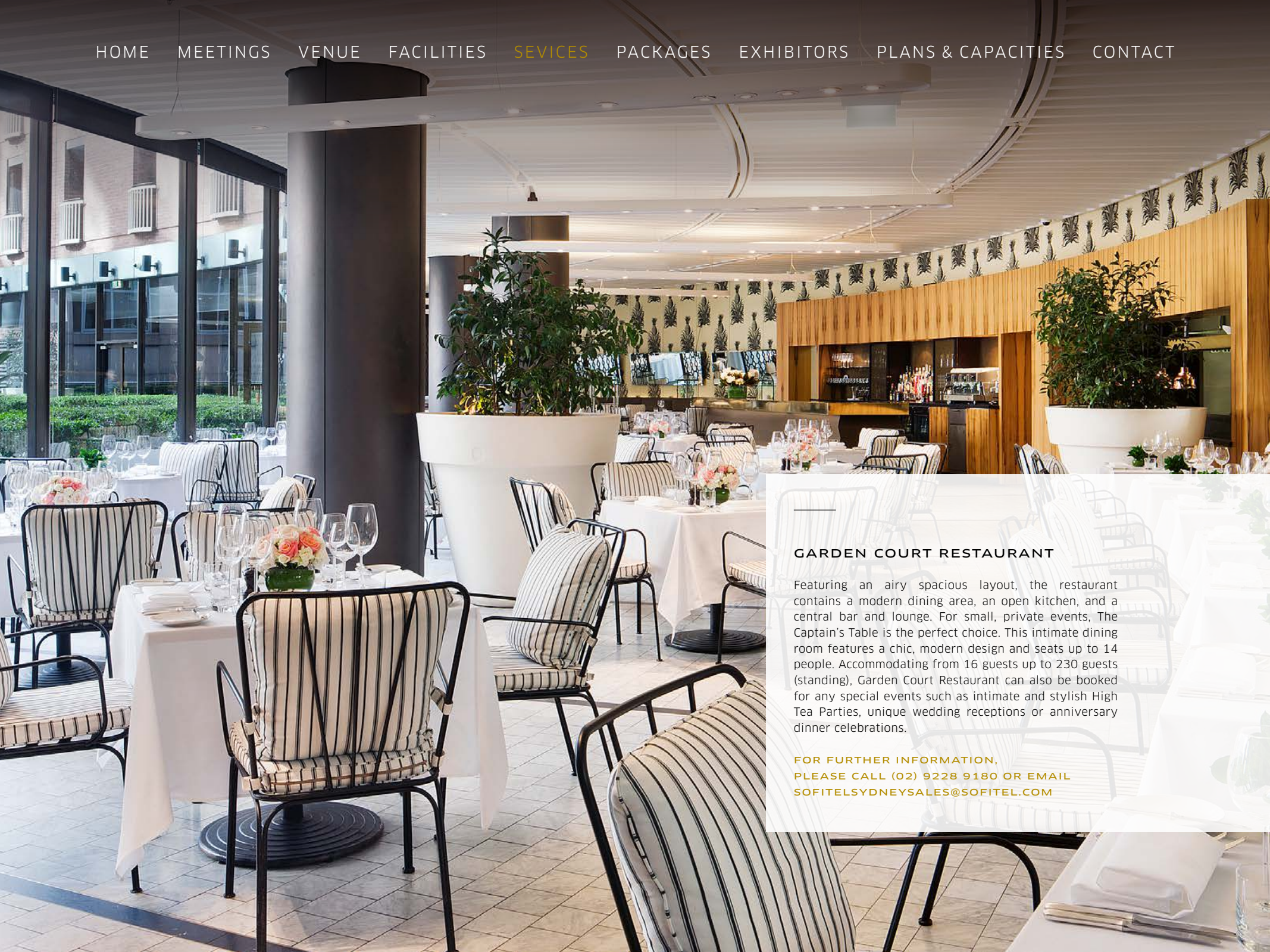

GARDEN COURT RESTAURANT

Featuring an airy spacious layout, the restaurant contains a modern dining area, an open kitchen, and a central bar and lounge. For small, private events, The Captain's Table is the perfect choice. This intimate dining room features a chic, modern design and seats up to 14 people. Accommodating from 16 guests up to 230 guests (standing), Garden Court Restaurant can also be booked for any special events such as intimate and stylish High Tea Parties, unique wedding receptions or anniversary dinner celebrations.

FOR FURTHER INFORMATION,
PLEASE CALL (02) 9228 9180 OR EMAIL
SOFITELSYDNEYSALES@SOFITEL.COM

PACKAGES

Our selection of corporate packages have been specifically created to allow the event planning process to run as smoothly as possible. These include day delegate packages – with full and half-day options available – which feature a choice of break items, lunch and dinner options, and a variety of accommodation, ranging from our classic room to our luxury club king room with Club Sofitel access. Perfect for early morning breakfast conferences, intimate lunch meetings to grand cocktail functions. Our Ballroom is the perfect location for exhibitions and residential conferences with a dedicated floor for conferencing with breakout rooms and a dedicated ambassador working with the event organisers.

ALL INFORMATION ON OUR CONFERENCE
& EVENT PACKAGES IS AVAILABLE AT
SOFITELSYDNEY.COM.AU



EXHIBITORS

Accommodating up to 950 guests, the impressive Wentworth Ballroom and its spacious adjoining foyer offer a flexible exhibition space. Exhibitors can gain access to the Ballroom and the hotel's other function rooms via the loading dock. For larger items and items unable to be brought in through the loading dock, the car hoist may be used at a prearranged time (fees apply). Event organisers can choose to arrange wired and wireless internet access for event attendees, while a range of equipment is also available for hire, including projection and audio equipment, and exhibitor booth equipment. Sofitel can provide trestle tables, banquet chairs and power boards for each exhibitor booth. However all other furniture must be supplied by exhibitors or event organisers. The hotel can also provide an array of external contacts to accommodate further requirements.

**FOR CONFERENCE & EVENT ENQUIRES,
PLEASE CALL (02) 9228 9180 OR EMAIL
SOFITELSYDNEYSALES@SOFITEL.COM**

FLOOR PLANS

Conference in style at Sofitel Sydney Wentworth and discover our meeting room layouts and capacities.

[SECOND FLOOR](#) >

[THIRD FLOOR](#) >

[FOURTH FLOOR](#) >

[FIFTH FLOOR](#) >

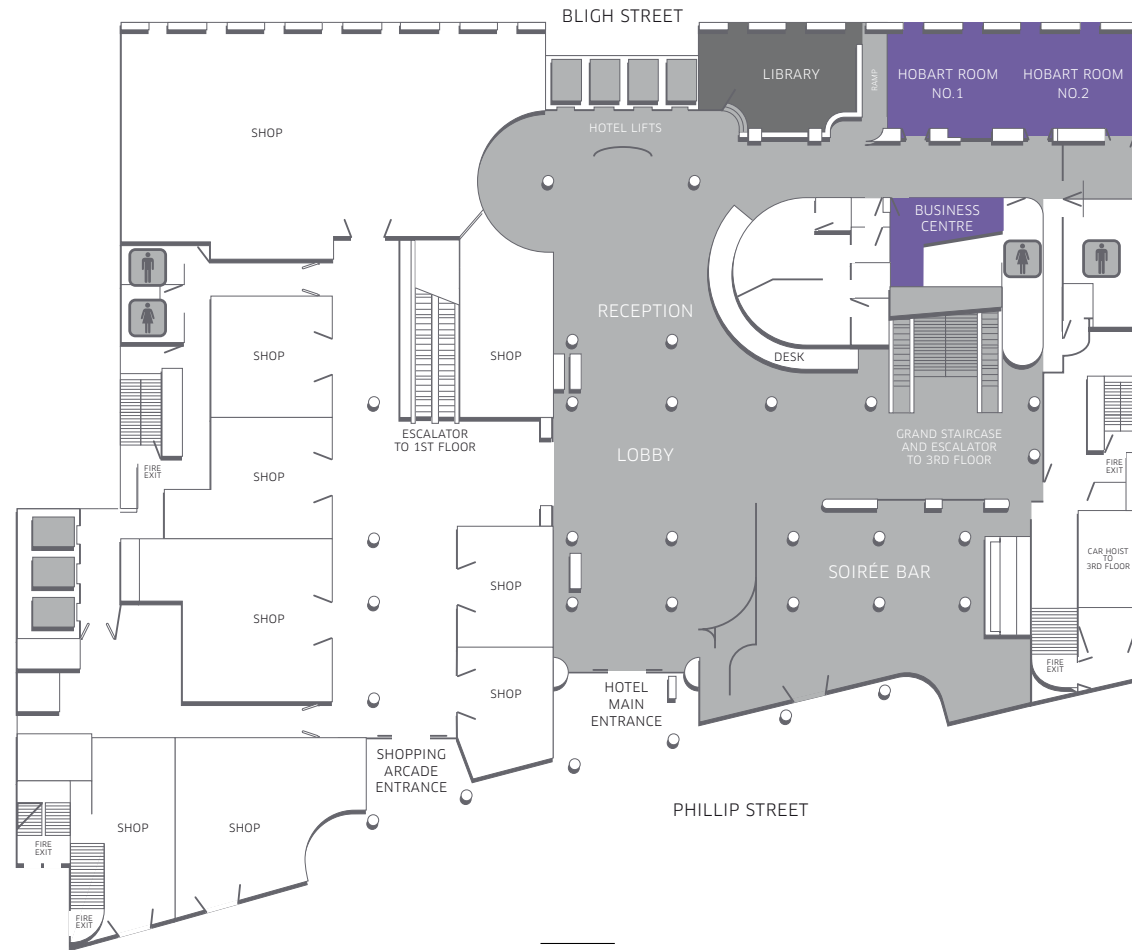

SECOND FLOOR MEETING ROOM LAYOUT AND CAPACITIES

ROOM NAME	AREA SQ.M	THEATRE STYLE	BANQUET STYLE SIT DOWN
HOBART ROOM 1 & 2	85	70	50
HOBART ROOM 1	39	24	20
HOBART ROOM 2	46	36	30

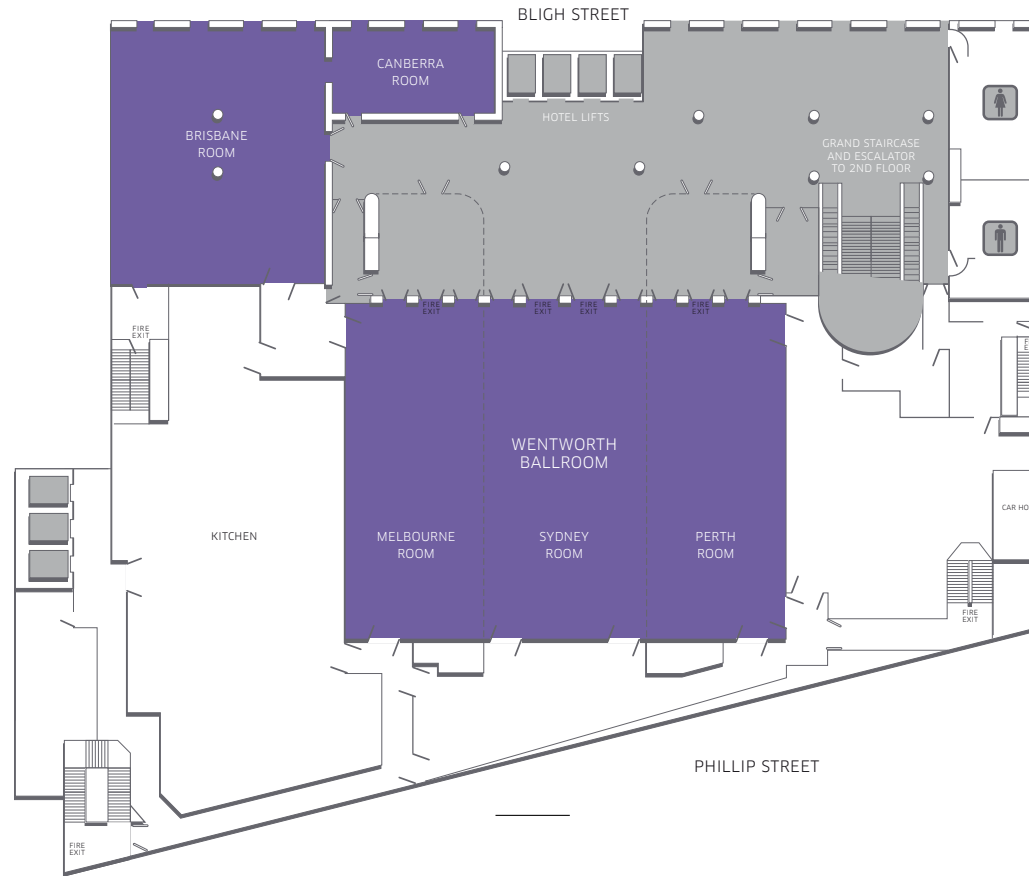

THIRD FLOOR MEETING ROOM LAYOUT AND CAPACITIES

ROOM NAME	AREA SQ.M	THEATRE STYLE	CLASSROOM STYLE	COCKTAIL STANDING	BANQUET STYLE SIT DOWN
GRAND BALLROOM	629	950	468	1100	580
SYDNEY ROOM	229	304	156	360	180
MELBOURNE ROOM	198	266	156	340	170
PERTH ROOM	198	266	156	340	170
BRISBANE ROOM	227	200	80	180	140
CANBERRA ROOM	55	30	27	40	40

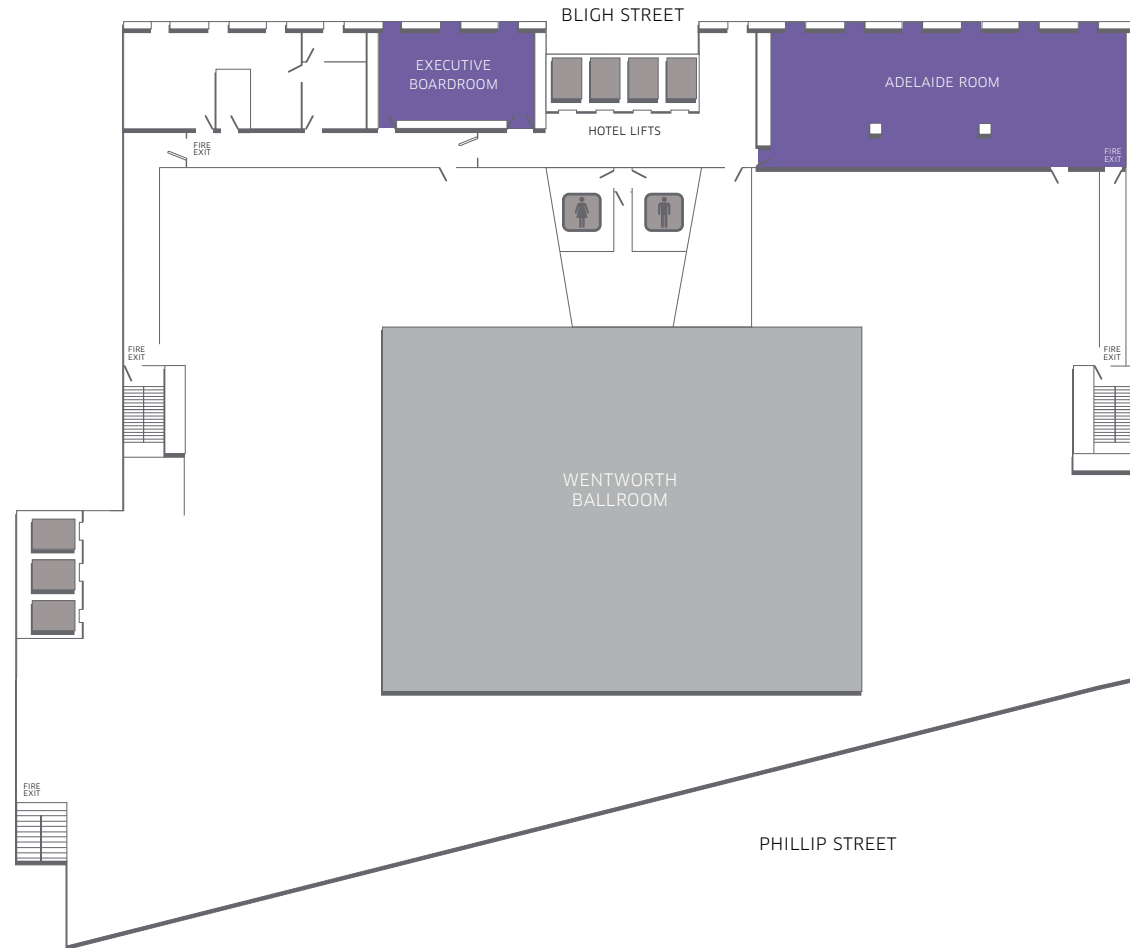

FOURTH FLOOR MEETING ROOM LAYOUT AND CAPACITIES

ROOM NAME	AREA SQ.M	THEATRE STYLE	CLASSROOM STYLE	COCKTAIL STANDING	BANQUET STYLE SIT DOWN	BOARDROOM
ADELAIDE ROOM	165	120	54	120	100	56
EXECUTIVE BOARDROOM	46	N/A	N/A	N/A	N/A	16

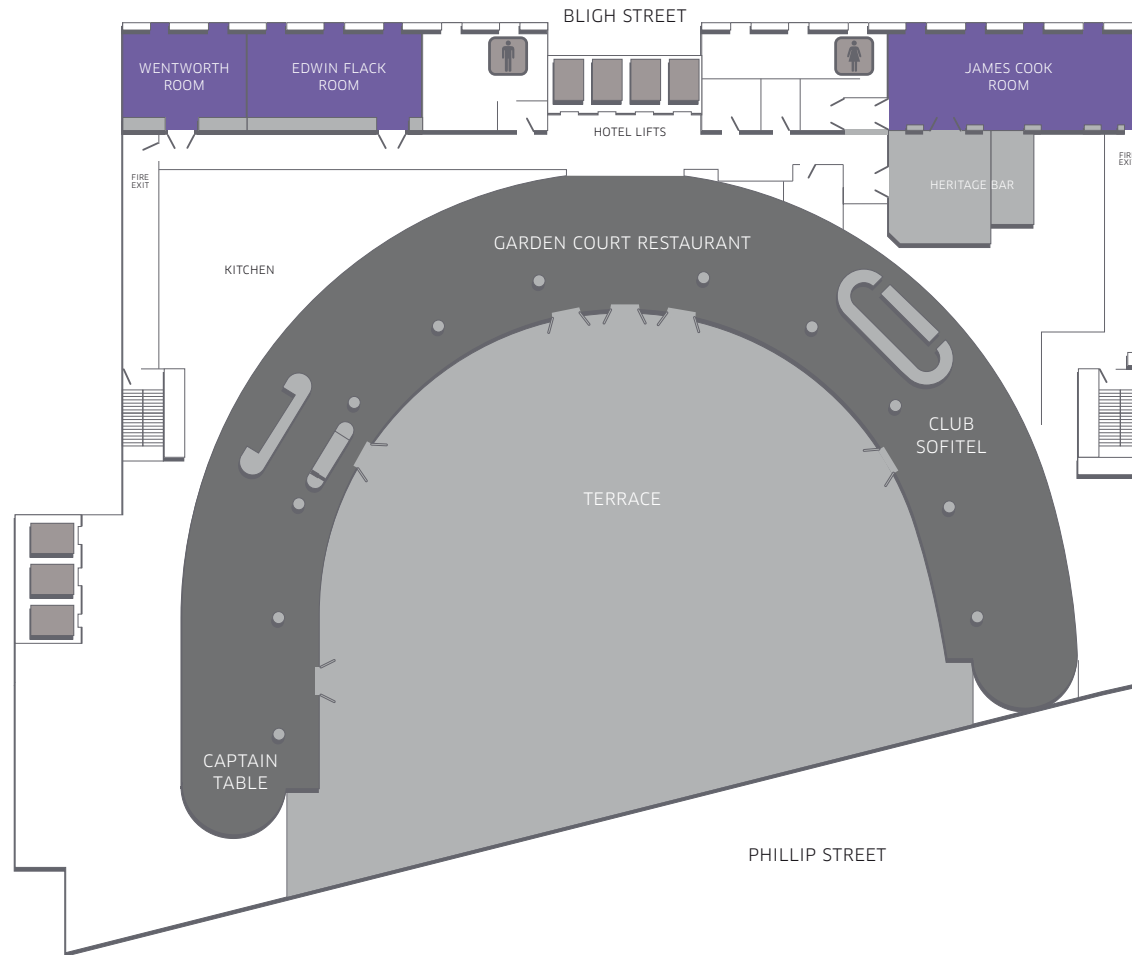

FIFTH FLOOR MEETING ROOM LAYOUT AND CAPACITIES

ROOM NAME	AREA SQ.M	THEATRE STYLE	CLASSROOM STYLE	COCKTAIL STANDING	BANQUET STYLE SIT DOWN
EDWIN FLACK ROOM	57	50	30	50	40
WENTWORTH ROOM	41	35	21	30	20

CONTACT US

FOR FURTHER INFORMATION,
PLEASE CONTACT OUR TEAM

CONFERENCE & EVENT ENQUIRES:

EMAIL: SOFITELSYDNEYSALES@SOFITEL.COM

TELEPHONE: (02) 9228 9180

WEDDING ENQUIRES:

EMAIL: SOFITELSYDNEYSALES@SOFITEL.COM

TELEPHONE: (02) 9228 9180

ACCOMMODATION:

EMAIL: H3665@SOFITEL.COM

TELEPHONE: 1800 676 960

ALL INFORMATION ON OUR CONFERENCE
& EVENT PACKAGES IS AVAILABLE AT
SOFITELSYDNEY.COM.AU/INSPIREDMEETINGS



#SOFITELSYDNEY #INSPIREDMEETINGS

SOFITEL SYDNEY WENTWORTH

61-101 PHILIP STREET, SYDNEY NSW 2000, AUSTRALIA