

S O F I T E L  
LUXURY HOTELS

THE PALM, DUBAI

MAGNIFIQUE RESORT RETREAT







Be captivated by a fresh blend of Polynesian-inspired architecture and Arabian hospitality in the breath-taking setting of Palm Jumeirah, Dubai. A welcoming haven of paradise, this stunning resort overlooks the enticing waters of the Arabian Gulf, offering a relaxing retreat, enthused with elegant luxury for an unforgettable stay.



DUBAI, A WORLD CONNECTED DESTINATION

OVER 90 AIRLINES PROVIDING DIRECT FLIGHTS  
FROM OVER 140 CITIES WORLDWIDE



MAJOR CONNECTIONS

EUROPE		THE AMERICAS		ASIA PACIFIC		MIDDLE EAST, AFRICA	
London	07:00	New York	07:00	Moscow	06:30	Beirut	03:10
Frankfurt	06:30	Washington	07:00	Mumbai	02:55	Cairo	03:40
Paris	07:00	Los Angeles	07:00	Bangkok	06:00	Riyadh	01:40
Rome	06:00	Toronto	07:00	Singapore	07:25	Doha	01:00
Geneva	06:00	Rio de Janeiro	07:00	Shanghai	07:00	Manama	01:10
Madrid	07:30	Sao Paulo	07:00	Sydney	13:40	Johannesburg	08:00

STEP ONTO PALM JUMEIRAH

The pulsating city of Dubai is a unique blend of East and West, the ancient and the modern, along with timeless deserts and golden beaches.

Sofitel The Palm Dubai is located on the East Crescent of the iconic Palm Jumeirah, the world's largest man-made island shaped in the form of a palm tree.

A retreat from Dubai's urban cityscape, just 35 minutes' drive from Dubai International Airport and a few minutes from Dubai's main business areas Media/Internet City and leisure areas Dubai Marina.





# POLYNESIAN WELCOME

Located on the prestigious Palm Jumeirah, Sofitel The Palm is a Polynesian themed resort, comprising 546 keys. Alluringly close yet away from the bustling city, the resort sprawls over a long private beach on the East Crescent. The hotel offers a large variety of dining options with 14 restaurants and lounges.

Indulge in one of the 4 outstanding private villas or delight in the airy, subtly energising atmosphere of 360 contemporary guest rooms and suites featuring large balconies and gorgeous sea views or Palm views.



## TROPICAL ALLURE

**360 rooms and suites**  
**4 private villas**  
**182 serviced apartments**

- ☞ Sofitel MyBed™ concept
- ☞ Lanvin & Hermès amenities
- ☞ 7 restaurants with terrace
- ☞ 7 bars and lounges
- ☞ 1 nightclub
- ☞ 6 pools
- ☞ 500m private beach
- ☞ Luxury So Spa
- ☞ Complimentary kids club access
- ☞ 1 cinema for kids
- ☞ So Fit health club
- ☞ 2 tennis courts
- ☞ 1 ballroom
- ☞ 8 meeting rooms
- ☞ Complimentary wifi
- ☞ Complimentary shuttle buses



# ACCOMODATION

Combining understated luxury with utmost comfort, all guest rooms showcase onyx laden bathroom features, deluxe French amenities such as Lanvin and Hermes along with Sofitel's MyBed™ concept - an all-feather bed and extra light down duvet.

Capturing elements of traditional Polynesian architecture, the

exotic woods and centered stone bathtub, overlook the rest of the living space and private balconies, offering a mini haven of exotic luxury and relaxation.

Guests can treat themselves to either rooms, villas or serviced apartments ideal for families with children or for lengthier stays.



LUXURY ROOM



JUNIOR SUITE



PRESTIGE SUITE



BEACH SUITE

## DIVE INTO MY BED

### 237 CLASSIC AND LUXURY ROOMS

- 26 Twin Bedrooms - 44 sqm
- 211 King Bedrooms - 44 sqm

### 124 LUXURY SUITES

- 50 Junior Suites - 60 sqm
- 22 Prestige Suites - 85 sqm
- 42 Beach Suites - 85 sqm
- 8 Opera Suites - 125 sqm
- The Palm Suite - 450 sqm

### 182 LUXURY SERVICED APARTMENTS

- 97 One-Bedroom Apartments - 75 sqm
- 82 Two-Bedroom Apartments - 135 sqm
- 3 Three-Bedroom Apartments - 265 sqm

### 4 PRIVATE VILLAS

- The Beach Villa - 345 sqm
- 3 Lodge Villas - 750 sqm



# THE HEIGHT OF LUXURY

For those who are looking for the ultimate luxury, the Palm Suite, offering 4 bedrooms, top floor location, own signature terrace and incredible views of both The Palm and the Arabian Gulf provides the essence of living in luxury.

With welcoming and timely transportation of your choice, your stay with us begins before you even arrive at the resort.

Upon arrival, the discrete yet attentive 24-hour butler service coupled with exclusive access to the Club Millésime lounge allow you to relax into your surroundings. As the sun sets, a stroll along the 500-meter private beach or a treatment at the majestic spa in a private cabana completes your perfect day and sets the tone for the rest of your stay at Sofitel The Palm, Dubai.



BEACH SUITE



BEACH VILLA



PALM SUITE



LODGE VILLA



OPERA SUITE



PRESTIGE SUITE

## A WORLD OF PRIVILEGES

3 LODGE VILLAS | 1 PALM SUITE | 1 BEACH VILLA | 8 OPERA SUITES | 42 BEACH SUITES | 22 PRESTIGE SUITES

- 🔗 Club Millésime™ lounge access
- 🔗 Reception assistance
- 🔗 Concierge assistance
- 🔗 A selection of international newspapers and magazines
- 🔗 24-hour butler service

- 🔗 Business center services
- 🔗 Breakfast from 6:30am to 11:00am in the lounge
- 🔗 All day tea, coffee, mineral water and light bites
- 🔗 Evening Millésime™ wine tasting/aperitif

- 🔗 Complimentary pressing
- 🔗 Complimentary use of the lounge's meeting room per day



# DINING

Synonymous with the French art de vivre, culinary excellence is one of the cornerstones of the Sofitel experience. Sofitel The Palm Dubai is no exception with 14 restaurants and lounges combining to present a truly international flavour and celebrate food with French touch.

Taste the aromatic influences from different continents of

the world, be it Asia, Europe or the Americas to satisfy all food cravings. Both indoors and al fresco options along with magnifique views immerses diners in a culinary journey of excellence across the resort.



HONG LOONG



BEACH CABANA



BOTTEGA



MOANA TERRACE



PORTERHOUSE



MANAVA

## THE TASTE OF BON GOUT

- Porterhouse - Succulent Steaks & Grills, classic elegance and star-lit dining
- Hong Loong - Traditional Chinese cuisine with a contemporary twist
- Moana Seafood - Delicacies from the sea creatively prepared
- Manava - International buffet for breakfast & dinner
- Maui Beach - Beachside light fare & Arabic grills
- Bottega - Italian cuisine with American influence
- Cabanas - Romantic beachside dining on request



# BARS AND LOUNGES

For those who wish to experience the sun go down, with a drink in one hand or catch all the live sporting action, there are plenty of venues to choose from.

Varying from lively to laid back, relaxing and socialising is always an option at any hour of the day. Enjoy cocktails or fresh fruit juices on the rooftop or by the pool, wide ranges of

wines by the glass for connoisseurs or the irresistible scent of fresh coffee, chocolate and French pastries. Sample the fragrant flavours of shisha in a soothing ambiance on the outdoor terrace with incredible views over Palm Jumeirah.



MAUI TERRACE



LOBBY LOUNGE



PORTERHOUSE BAR



MAUI ROOFTOP



POOL TERRACE



PORTERHOUSE SPORTS BAR

## CHEERS OF HAPPINESS

🔗 **Lobby Lounge** - Irresistible scent of fresh coffee, chocolate and French pastries

🔗 **Maui Beach Bar** - Cocktails, fresh fruit juice on the rooftop or by the pool

🔗 **Porterhouse Bar** - Lively, trendy vibes for pre-dinner aperitif

🔗 **Porterhouse Sports Bar** - Catch the live sporting action and a game of billiard

🔗 **Hong Loong Street** - Traditional Asian décor for authentic Chinese delicacies

🔗 **The Library** - Cozy atmosphere and intimate setting for reading

🔗 **O2 Nightclub** - Dubai's newest and trendiest nightclub

🔗 **Gelati Ice-cream** - Ice cream flavours & refreshments



# INSPIRED MEETINGS

With a wide selection of meeting rooms and an elegant ballroom, Sofitel The Palm Dubai is the premier destination for corporate and private entertaining. Our dedicated InspiredMeetings™ planners will work meticulously to create the perfect environment for your guests, blending French flair with local style for a high impact event. Treat your guests or business associates to a large

or small-scale meeting with luxurious conference facilities or exciting team-orientated elements for incentives. The conference facility offers a refreshing alternative to conventional meeting settings, with 8 meeting rooms and a ballroom encompassing the rich heritage of Polynesian design.



BOARDROOM



TAHITI MEETING ROOM



BORA BORA MEETING ROOM

## BESPOKE CHOICES

- 8 meeting rooms, with 3 boasting natural daylight
- Ballroom accommodating up to 700 guests
- Dedicated entrance to the conference center
- State of the art sound and video systems
- Wireless Internet throughout the resort
- Devoted InspiredMeetings™ planners
- Dedicated technical team
- Full service business center
- Direct access to all-day dining restaurant



BALLROOM THEATRE



# EVENTS

## INDOOR

Depending on the scale of your event, our meeting spaces can be configured to suit any seating arrangement and requirement. Be it theatre, banquet or classroom style, the options to transform the space are endless. From corporate cocktail receptions to car launches, fashion shows and private family celebrations, every function is hand-crafted to perfection leaving a lasting impression for all.



## OUTDOOR

Our magnifque lush gardens offer endless possibilities and the perfect backdrop for outdoor events. The immaculate grounds cater to fairytale tea parties, picnics with an idyllic island feel, romantic cabana dinners by the beach or barbecues on the carpeted lawn. Whatever it is that you require, our dedicated InspiredMeetings™ planners will endeavour to make every aspect of your event a success.



## INSPIRING VENUES

### INDOOR

- ☞ The Library
- ☞ Moana Restaurant
- ☞ Maui Beach Restaurant
- ☞ Porterhouse & Sports Bar
- ☞ The Jetty
- ☞ The Palm Suite
- ☞ The Lodge & Beach Villas
- ☞ The Kids Club
- ☞ Meeting Rooms & Ballroom

### OUTDOOR

- ☞ Grass lawn
- ☞ Maui Terrace
- ☞ Maui Rooftop
- ☞ Moana Terrace
- ☞ Porterhouse Terrace
- ☞ Lodge Villa Garden
- ☞ Palm Suite Terrace
- ☞ Beach Cabanas
- ☞ Beach



# WEDDINGS

Begin your lifelong journey in the midst of romance and a luxurious Polynesian setting. With a variety of elegant indoor and outdoor solutions, finding a venue for life's most treasured moment is the easiest of choices. Whether it's an intimate gathering or an extravagant celebration for 700 guests within a stunning garden setting or a traditional indoor event, every

detail of your celebration will be arranged beautifully. Exchange vows and celebrate your most special day with French flair and a dedicated Wedding Planner who will be with you every step of the way. Exquisite touches that are seamlessly tailored and a range of personalised services will make for the ideal fairytale wedding.



## MAGNIFIQUE DETAILS

- Pre-event functions
- Décor including table settings, theming
- Floral bouquets
- Ceremonial wedding cake
- Bespoke menu creations
- Sound, lights and live entertainment
- Photographic memories
- Bridal beauty treatments
- Chauffeur service
- Childcare





# CAPACITIES & FLOOR PLAN

MEETING ROOMS	AREA M²	LENGTH M	WIDTH M	CLASSROOM	THEATRE	U SHAPE	BOARD ROOM	DINNER	COCKTAIL
BOARD ROOM	110	11	10	-	-	-	24	-	-
TAHITI	49	9	5.4	18	25	20	18	-	-
BORA BORA	50	9	5.6	18	25	20	18	-	-
MAUPITI	63	9	7	20	30	25	20	-	-
MOOREA 1	275	12	23	90	215	51	48	170	230
MOOREA 2	265	11.5	23	90	215	51	48	170	230
MOOREA 3	275	12	23	90	215	51	48	170	230
MOOREA 1 + 2 + 3	815	35.5	23	270	650	-	-	510	700
PRE-FUNCTION	480	32	15	-	-	-	-	-	400

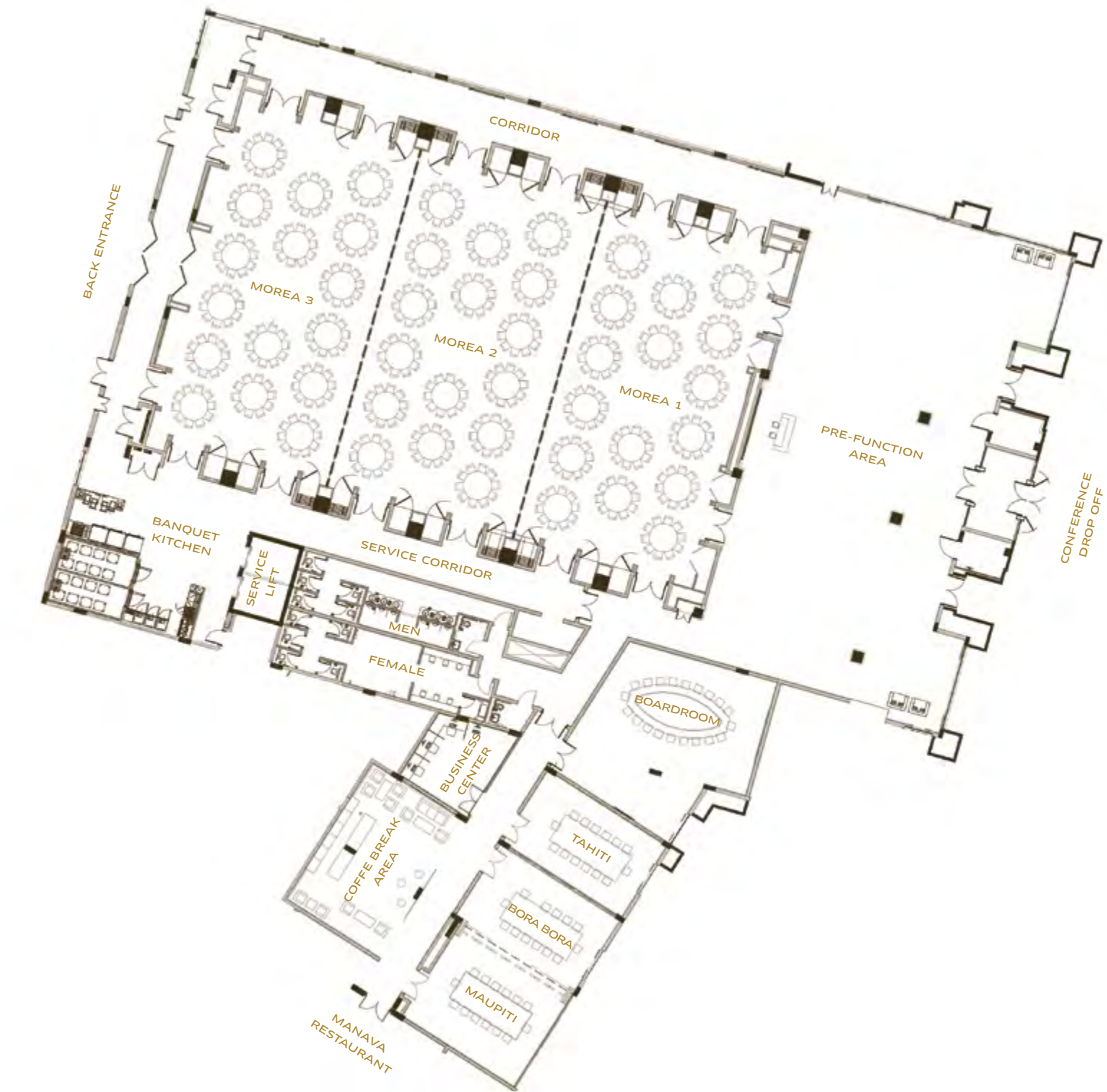



# SPA AND BEAUTY

Inspired by the incomparable beauty of the butterfly, So Spa reinforces relaxation and rejuvenation. Guests can immerse themselves in the 2,500 square meter spa area encompassing 28 treatment rooms, offering revitalising massages, facials and body treatments in an idyllic Polynesian setting. The So Spa at Sofitel The Palm believes in creating unique,

personalised and long lasting spa experiences. The So Spa philosophy is to combine the richness of natural ingredients, latest research in cosmetology and professional expertise through made-to-measure prescriptions and treatments which nurture the body while providing immediate and optimum results.



## REVITALISE YOUR SENSES

- 28 treatment rooms
- 4 outdoor cabanas
- 5 pools including plunge pool, therapeutic pool, outdoor infinity pool
- 2 steam rooms
- Fitness studio
- Hair salon for ladies and gents





# RECREATION AND SO FIT

Open 24 hours a day, So Fit is a round the clock fitness destination equipped with top of the range Technogym equipment, offering professional instruction from 6am until 10pm, and a variety of innovative activities designed to keep motivation levels high. Personal training packages are available for one-to-one coaching and other pursuits on offer include tennis lessons, swimming

lessons for all ages, LPG training and boot camp classes. After a rigorous workout, guests can relax in separate sauna and steam rooms in the male and female changing areas.



## STAY ACTIVE

- Large fitness health club
- 6 outdoor pools including kids pool with slides
- 2 tennis courts
- 1 multi purpose court
- Boutiques
- Private 500m beach
- Watersports
- Teamsports
- Tennis
- Eco Golf
- Gaming Zone





# KIDS CLUB

Let little imaginations take flight at Sofitel The Palm Dubai's Amura Kids Club, where our experienced team is on hand to entertain children with a whole host of fun and games from 9am until 8pm.

Designed for kids between the ages of four and twelve, an engaging programme of organised events, including face

painting, yoga, pilates, origami and mini disco, is guaranteed to keep spirits high throughout the day.



## PLAYFUL PARADISE

- Private kid's playground
- 2 swimming pools
- 2 baby pools
- In room baby-sitting service
- Daily kids activities
- 1 cinema
- 1 ice cream shop
- Complimentary access





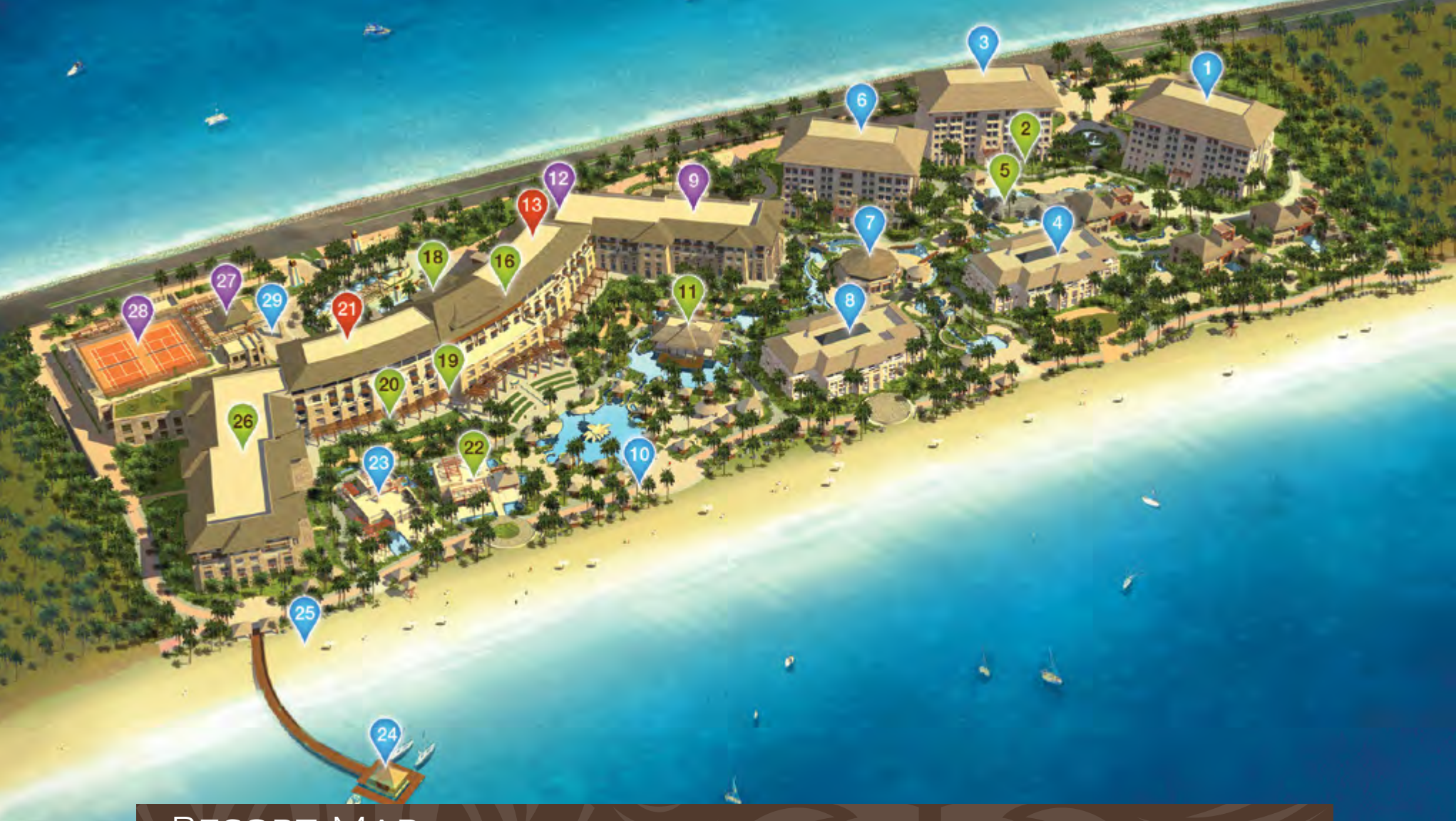

## RESORT MAP

### RESTAURANTS, BARS & LOUNGES

- 26 MANAVA - ALL DAY DINING
- 22 MAUI BEACH RESTAURANT & BAR
- 11 MOANA - SEAFOOD RESTAURANT
- 20 PORTERHOUSE STEAKS & GRILLS
- 18 HONG LOONG - CHINESE CUISINE - 2<sup>ND</sup> FLOOR
- 2 BOTTEGA AMERICAN & ITALIAN
- 16 LOBBY LOUNGE
- THE LIBRARY - 1<sup>ST</sup> FLOOR
- 19 PORTERHOUSE BAR
- PORTERHOUSE SPORTS BAR - 1<sup>ST</sup> FLOOR
- 5 GELATI - ICE CREAM

### RESORT FACILITIES

- 6 APARTMENTS KORU 1
- 3 APARTMENTS KORU 2
- 1 APARTMENTS KORU 3
- 8 BEACH SUITES TIARE 1
- 4 BEACH SUITES TIARE 2
- 23 THE BEACH VILLA
- 7 KID'S CLUB
- 10 RECREATION COUNTER
- TOWEL COUNTER
- 24 THE JETTY
- 25 WATERSPORTS
- 29 CONFERENCE CENTRE - G<sup>D</sup> FLOOR

### SHOPS

- 13 SHOPPING ARCADE
- 21 SHOPPING ARCADE

### BEAUTY & WELLBEING

- 27 SOFIT HEALTH CLUB - 1<sup>ST</sup> FLOOR
- 28 TENNIS COURT & SHOP - 2<sup>ND</sup> FLOOR
- 12 HAIR & BEAUTY SALON
- 9 SOSPA



## SOFITEL THE PALM, DUBAI

Palm Jumeirah - East Crescent Road P.O. Box: 555 58, Dubai, United Arab Emirates  
Contact No: +971 44 55 66 00 Email: H6541@sofitel.com

[WWW.SOFITEL-DUBAI-THEPALM.COM](http://WWW.SOFITEL-DUBAI-THEPALM.COM)



SOFITEL PALM

